



Working in  
partnership with

HS2



# A43 weekend carriageway closures

## Presentation delivered by

Anita Solanki EKFB – Head of Interface

Tom Woodward Kier Transportation - Senior Project Manager



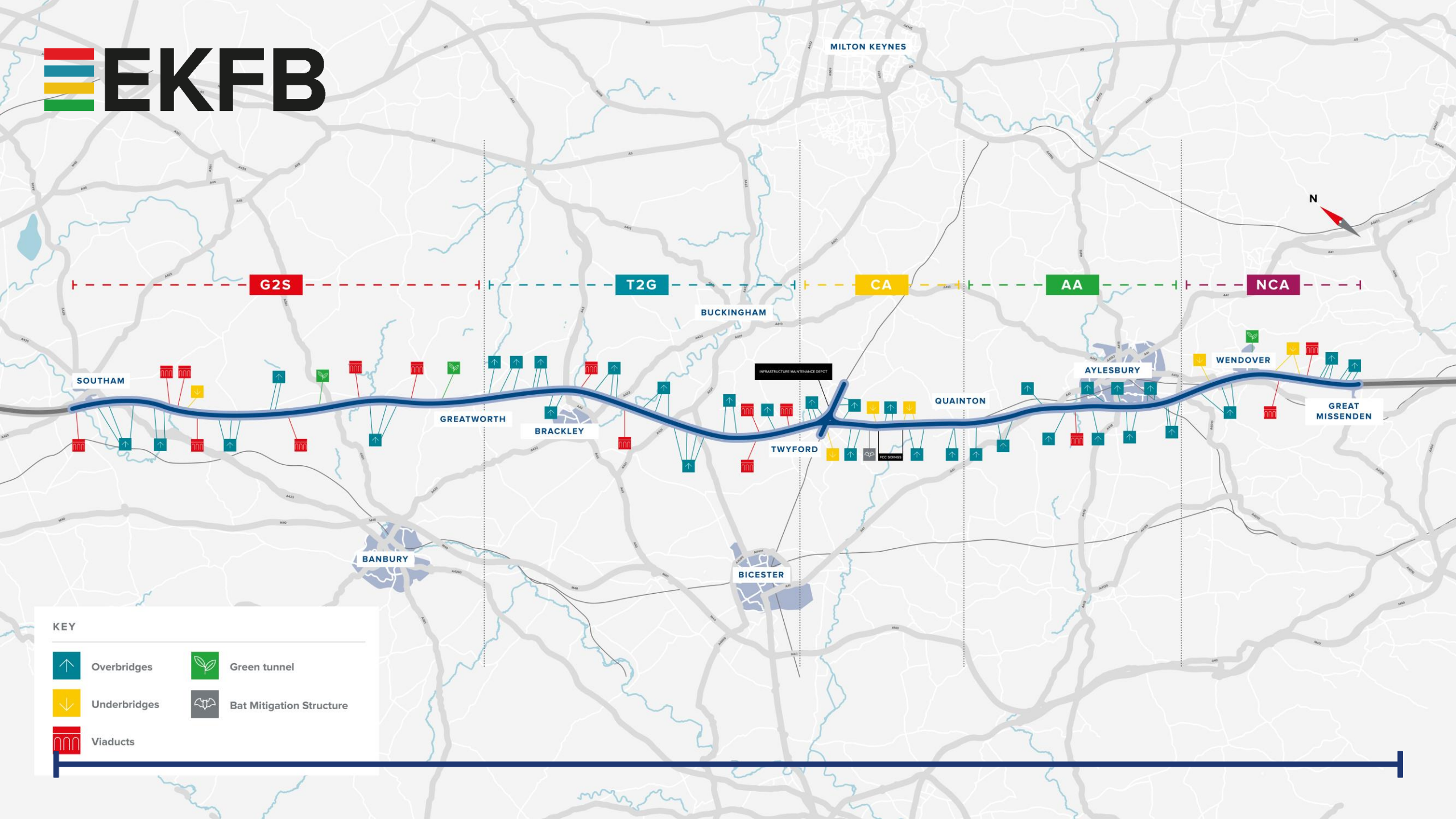

# Agenda

- Introductions
- EKFB and project location
- A43 scheme overview
  - Weekend closure overview
  - Alternative methods considered
  - Impact
  - Program
- Diversion routes
- Stakeholder plan
- AOB





**KEY**

	Overbridges		Green tunnel
	Underbridges		Bat Mitigation Structure
	Viaducts		

# Twyford to Greatworth (T2G) Project at a glance

## MAINLINE



20 km

## STRUCTURES



5 Viaducts

21 Over Bridges

## EARTHWORKS



1,2 M m<sup>3</sup> Topsoil  
6,7 M m<sup>3</sup> Excavation  
3,8 M m<sup>3</sup> Fill  
2,9 M m<sup>3</sup> Export

## OTHER

Road Realignment  
in line construction with  
temp diversion + OB

2.2km Drainage

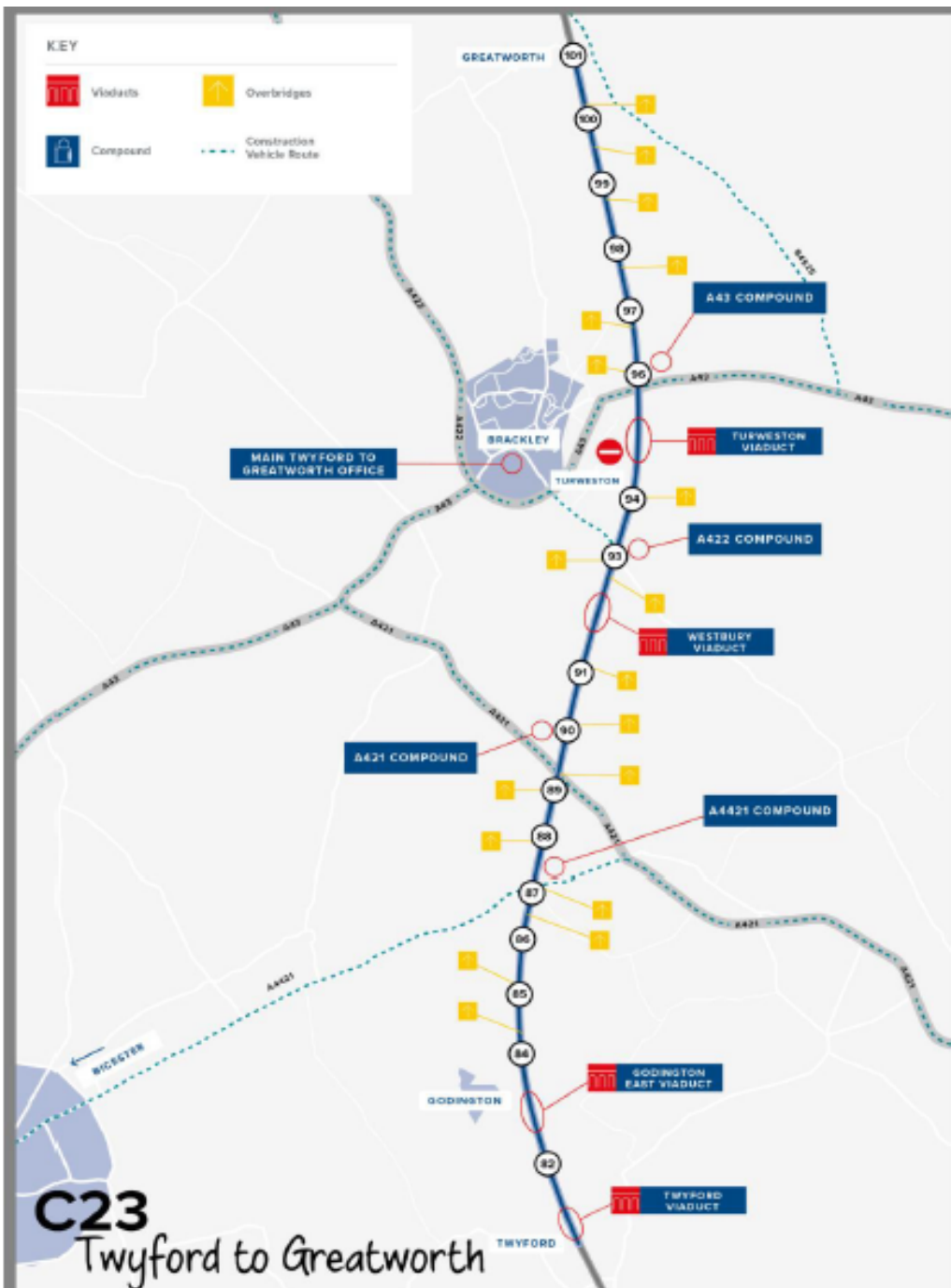



# A43 Overbridge

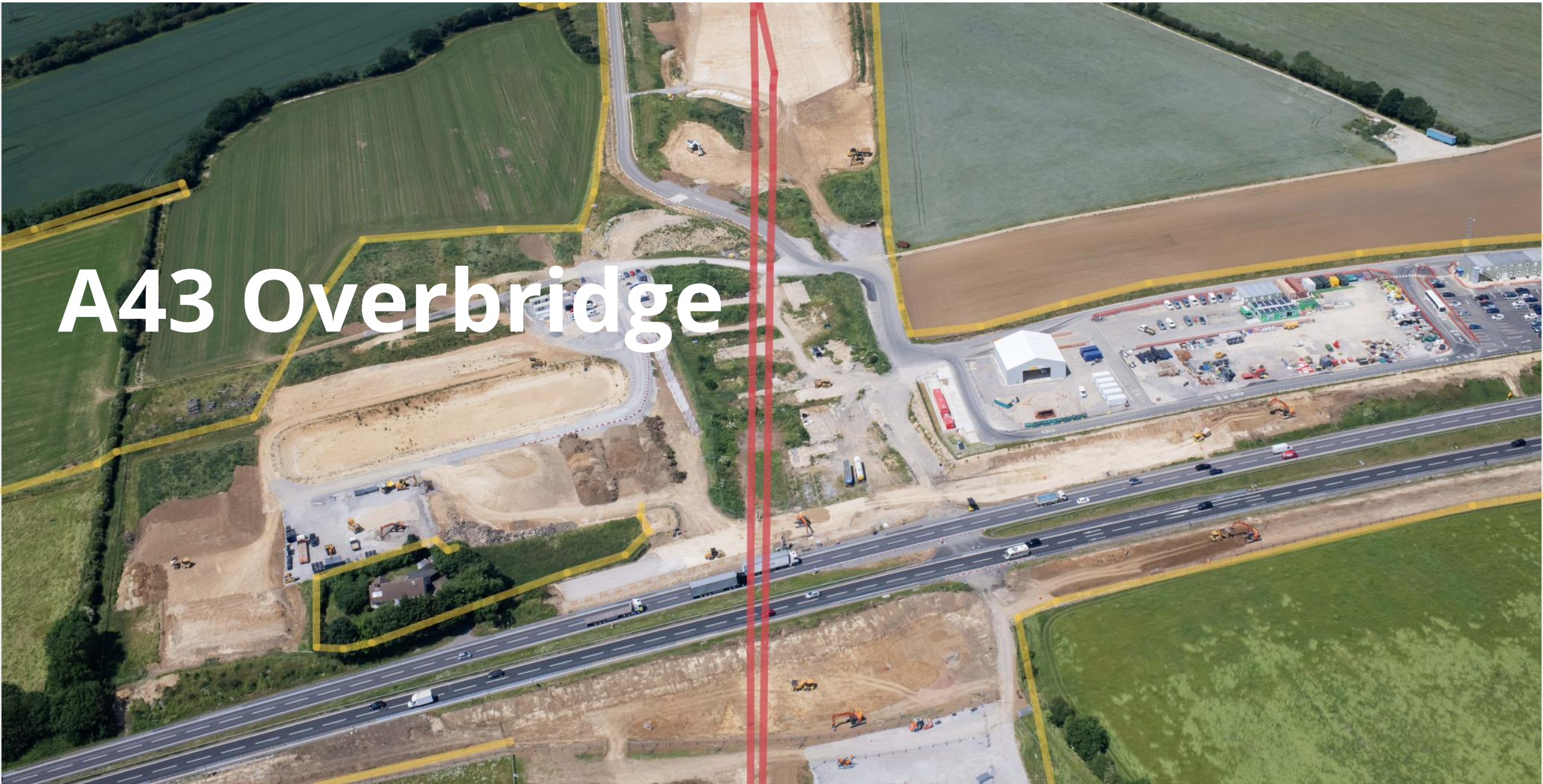



# Scheme Overview

## Phase 1

May 2023-  
November 2023



## Weekend Closures

Planned NB-Friday 17<sup>th</sup> November  
Planned SB-Friday 01<sup>st</sup> December  
Contingency NB-Friday 08<sup>th</sup> December  
Contingency SB-Friday 15<sup>th</sup> December



## Phase 2

December 2023-  
Spring 2025

Construction of temporary diversion route



- Installation of open cut drainage connections
- Tie in pavement detail between the temporary diversion route and the existing A43
- Realign exiting A43 onto the temporary diversion route

Construction of the permanent bridge

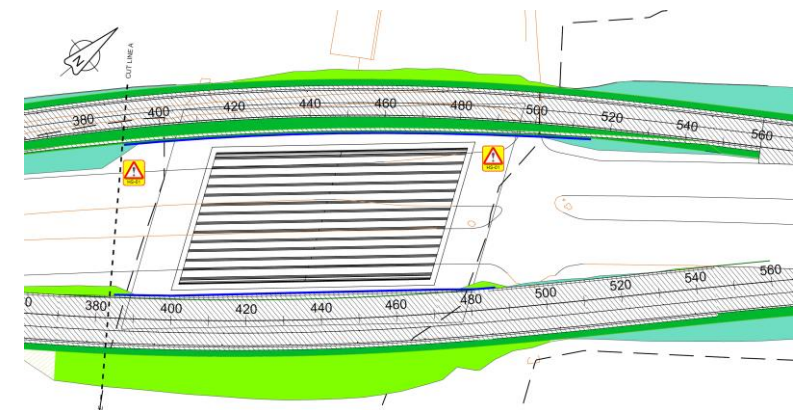

# Scheme Location Overview

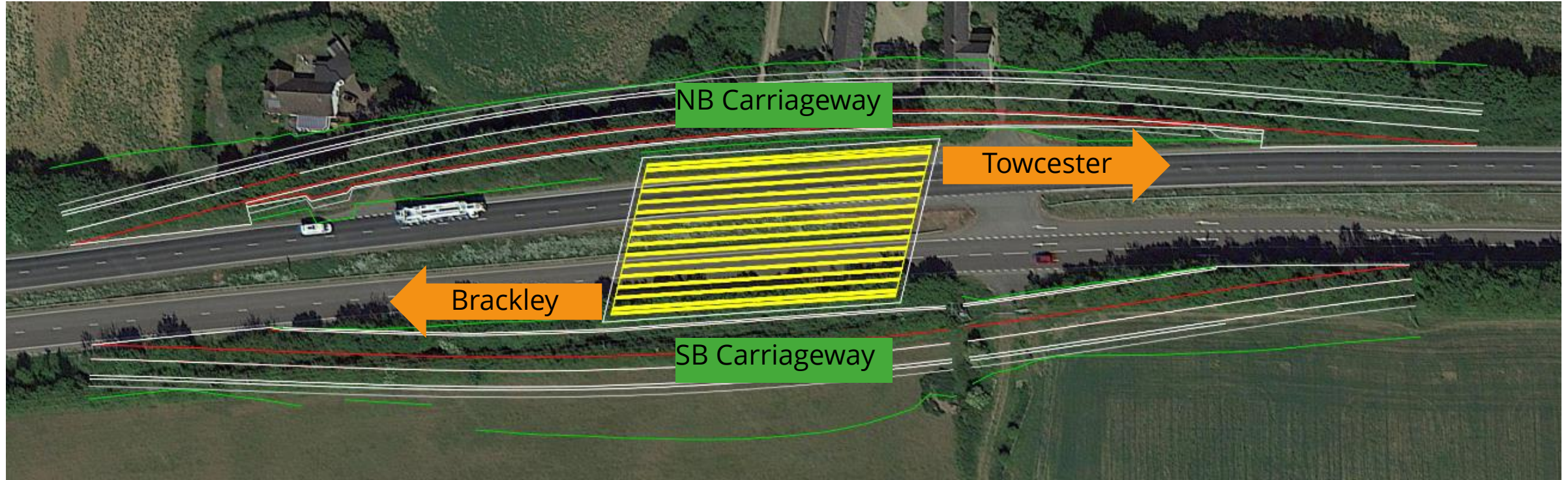



# Weekend Closure Overview

Open  
Cut  
Drainage

- 3 number crossing NB
- 1 number crossing SB
- Full carriageway reinstatement will be required for each of these crossings

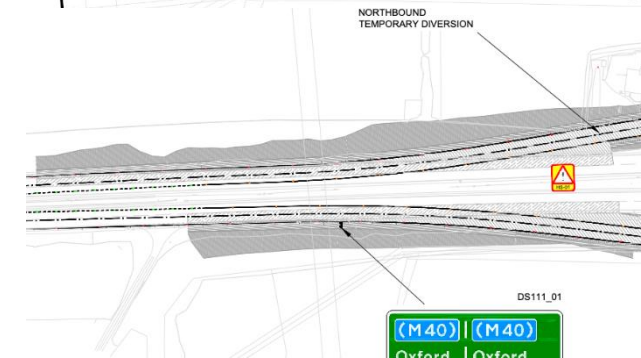
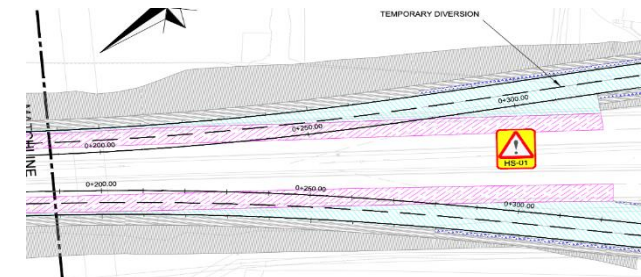
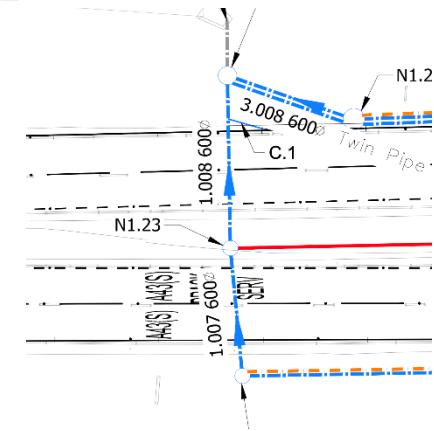

Pavement  
Detail

- Diversion route to be tied into the existing carriageway. This will include excavation, installation of type 1, pavement construction. This will require alteration to the existing carriageway to achieve the required levels and the stipulated tie in details for the various layers or bituminous surfacing

Realign A43

- Remove existing lining
- Install new lining
- Realign/install temporary VRS
- Switch traffic following final inspections and communications with the ROC



# Alternative Methods Considered

## Full Time Single Lane Closures

- Insufficient space to carry activities safely

## Single Night Full Closures

- Insufficient time to install drainage and reinstate full depth pavement

## Thrust Bore

- Insufficient space due to LLAU
- Ongoing night-time lane closures required to provide safety zone
- Potential long-term settlement of carriageway

# Impact

## Safety

- Total exposure time to TM operatives kept to a minimum
- No traffic exposure to construction workforce
- No requirement for ongoing night-time lane closure
- Appropriate contingency allowed for
- Appropriate time allowed for full pavement construction
- Lighting covered under GG104 SRA

## Customer

- Clash detection for public holidays, embargos and local events
- Weekend works avoids weekday carriageway closures on the SRN
- Less disruption to weekday commuters and logistics organisations
- All works completed in one road space booking per carriageway resulting in less ongoing disruption to the customer and local communities

## Delivery

- Collaboratively engaging with area teams to share road space opportunities
- Opportunity for cyclical maintenance with NH
- Weekend closures are key enabler to achieve program milestones
- On site security presence safeguarding against potential protestors



# Program

- **Planned NB-Friday 17<sup>th</sup> November**
- **Planned SB-Friday 01<sup>st</sup> December**
- **Contingency NB-Friday 08<sup>th</sup> December**
- **Contingency SB-Friday 15<sup>th</sup> December**
  
- Mitigation measures-Within the weekend closure there is 12 hours of contingency added to allow for any unforeseen circumstances which may arise such as:
  1. Breakdown to batching plant for surfacing and concrete, alternative plants will be on standby in case this happens
  2. Weather-Forecasts will be checked prior to the closure but in the event the forecast changes we have the contingency time to cover any potential delays it may cause
  3. "Go/No go" meeting will be held with all parties 48 hours before closure to ensure everything is in place before we "Go". Final update to NH to be provided 1200hrs on day of commencement



# Diversion route for non-motorway traffic avoiding A5 Towcester to Old Stratford

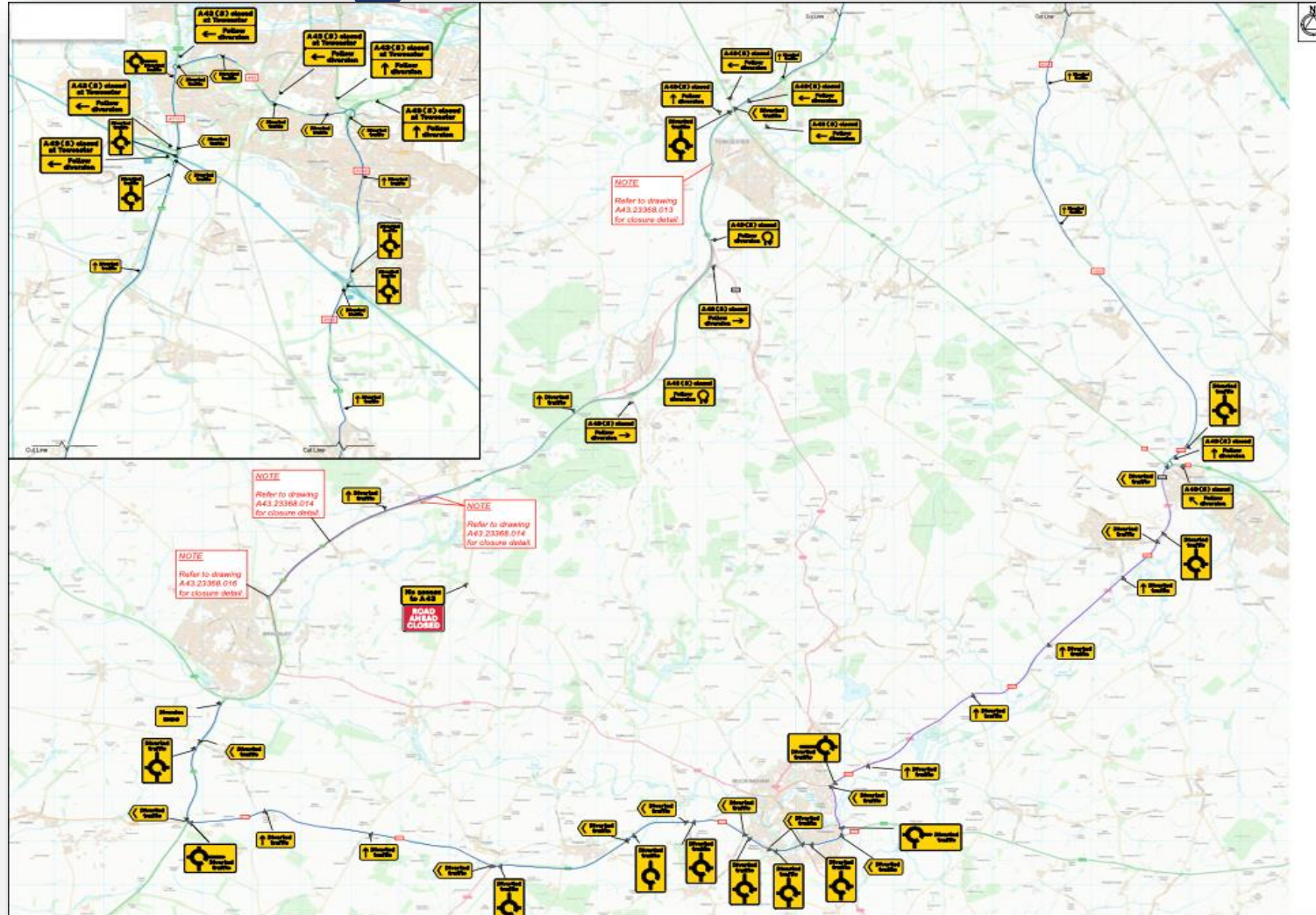

## SB shown NB in reverse

- Route avoids A5 through Towcester
- Local advertising of the closures
- Use of VMS signage locally and throughout the wider SRN
- Engagement with stakeholders, local authorities
- Through route for emergency services maintained

## Diversion Route from M1-Brackley

- M1
- A5123 through Northampton
- A45
- A508
- A422
- A413
- A421
- A43



# Stakeholder Plan



# Stakeholder Plan





















Stakeholder  
Mapping

Engagement  
Channels

External  
Communication  
Examples





Stakeholder	MTG	121 MTG	MVC	Newsletters	AWNs
National Highways				✓	✓
County Councils				✓	✓
Parish Councils		 		✓	✓
Wider Communities				✓	✓
Local Residents				✓	✓
Silverstone				✓	✓
HS2 Northants Liaison /Andrea Leadsom				✓	✓

### Assets required:

- Visual of road and bridge layouts;
- AWNs / Newsletters / Finalised comms plan
- Shared with ROC/ wider stakeholders /partnerships team /NH webpage /press offices
- Flyover footage of area
- VMS used locally and throughout the wider SRN.

- Andrea Leadsom MP/WNC sub-group stake holder meeting arranged (inc. Silverstone) 8<sup>th</sup> September – confirmed

# Engagement Planned & Forward Look

## Mobile Visitor Centre



- Turweston – 25 August
- Westbury – 25 Augst, 16 Nov TBC
- Syresham – 5 October , 16 Nov TBC
- Helmdon – 2 Nov TBC
- Turweston – 5 Oct TBC

## External Communications



- Advance Work Notice – June
- Summer Newsletter – A43 Specific , July
- Brackley Town Talk Magazine, July - Letter Drop - 7,000 Residential Properties & Businesses
- Advance Work Notice –August
- Autumn Newsletter – A43 Specific, Oct
- Brackley Town Talk – Oct – Letter Drop - 7,000 Residential Properties & Businesses
- EKFB Works Update Newsletter – Sept
- Advance Work Notice – Oct

## Meetings



- Brackley UA3 Presentation, July – 127 attendees
- Regular Parish Council Meetings & Updates
- Regular Meetings with National Highways
- Brackley – Meet the Team Event –Nov TBC

# External Communication Examples

Contact our HS2 Helpdesk team on 08081 434 434

## HS2 Update

A43 Overbridge Brackley | Summer 2023



High Speed Two (HS2) is the new high speed railway for Britain. You can sign up for regular updates in your local area at [www.hs2inyourarea.co.uk](http://www.hs2inyourarea.co.uk).

### Building HS2 near Brackley

Our newsletters are an important tool used to update local communities on the progress of the HS2 project. This newsletter has been created to specifically update the local communities on our work constructing the A43 Overbridge, near Brackley. It includes the latest information on upcoming construction activities and expected timelines.



The A43 Overbridge will carry traffic over the new High Speed Railway Line. The overbridge will be located between the Brackley BP roundabout and the A43 junction for Syresham.

Our preparatory works for the overbridge have involved utility diversions, extensive earthworks, temporary road and footpath the sole use of our construction teams as they travel up and down the project.

Throughout the spring of 2023, we have been preparing for the main construction phase of the new temporary diversion.

This has included the installation of temporary narrowed lanes and a reduction in the speed limit on this section of the A43. The new temporary diversion is expected to become operational in early 2024.

At the end of April, we began introducing periodic overnight closures of the A43, on both the southbound and northbound sides.

## Update Continued

Where possible, to minimise disruption, these overnight closures will be reduced to single lane closures.

Throughout the summer and into autumn, our activities will focus on earthworks, which will involve excavating approximately 11,000 cubic metres of material from the north side of the A43. This material will be temporarily stockpiled and eventually reused as part of the final landscaping designs for HS2.

Once we carry out our main earthworks for the temporary diversion, we will then begin installing drainage. Following the completion of the drainage works, we will begin constructing the new road, which will involve surfacing works, white lining and the installation of road signage. After the road is finished, the local authority will conduct a thorough road safety audit before it is opened for public use.

In order to safely tie in the new temporary diversion into the existing road network, we will require two 57-hour full road closures of the A43. To reduce disruption as much as possible, the northbound closure and the southbound closure will take place on alternate weekends. These closures are expected to take place in late 2023. Once dates are confirmed we will update the public two weeks in advance of the closures.

In addition to our formal Advance Work Notices, the road closure information will also be communicated through traditional road signage as well as electronic signage. These signs will be located in strategic locations and placed in a safe location.

Once the temporary diversion is operational, we will then be able to safely begin construction on the new A43 Overbridge, which is expected to be completed in late 2025.

We will continue to collaborate with National Highways and update local communities on the progression of our works. These works are currently subject to consents.

Should you have any questions about our works you can contact the HS2 helpdesk 24-hours a day.

### Contact us

Contact our HS2 Helpdesk team all day, every day of the year on:

Freephone **08081 434 434**  
 Minicom: **08081 456 472**  
 Email [HS2enquiries@hs2.org.uk](mailto:HS2enquiries@hs2.org.uk)

Write to: **FREEPOST HS2 Community Engagement**

Website [www.hs2.org.uk](http://www.hs2.org.uk)

To keep up to date with what is happening in your local area, visit: [www.HS2inyourarea.co.uk](http://www.HS2inyourarea.co.uk)

## Newsletter Update



## Notification

### Notice of overnight road closures, A43, Brackley BP roundabout to the Syresham junction

June 2023 | [www.hs2.org.uk](http://www.hs2.org.uk)

High Speed Two (HS2) is the new high speed railway for Britain. EKFB is working in partnership with HS2 Ltd to build the new high speed railway in your area. You can sign up for regular updates in your local area at [www.hs2inyourarea.co.uk](http://www.hs2inyourarea.co.uk).

#### What are we doing?

This spring, we will begin construction on a temporary diversion of a section of the A43. This diversion is required so that we can build the new A43 Overbridge that will carry traffic over the HS2 railway line. We will soon be installing narrowed lanes on the northbound side of the A43, along with road safety barriers. These narrowed lanes will remain operational into winter.

In order to carry out these works safely, there will be overnight closures of the A43. The lay-bys on the southbound side of the A43 will also be closed from Friday 28 April for approximately five weeks, allowing us to coordinate our plant and machinery for the overnight closures. The lay-by located opposite Illets Farm will remain closed for the duration of our works while we build the A43 Overbridge. For the safety of road users and our workforce there will also be speed restrictions on this section of road.

Once the narrowed lanes and safety barriers are installed, the main works to construct the temporary diversion will commence.

We will also be delivering plant and material to our works sites on the A43 as well as carrying out some localised vegetation clearance. To do this safely, there will be overnight closures of the A43 on some weekends. We will continue to collaborate with National Highways and update local communities on the progression of our works.

#### When will these works take place?

The A43 northbound will be fully closed overnight, from the Brackley BP roundabout to the Syresham Junction, from 8pm to 6am, on the following dates:

- Sunday 18 June and Sunday 2 July

The A43 southbound will be fully closed overnight, from the Brackley BP roundabout to the Syresham Junction, from 8pm to 6am on the following dates:

- Saturday 17 June and Saturday 1 July

#### Duration of works

The A43 southbound will be closed overnight on:

- Saturday 17 June
- Saturday 1 July

The A43 northbound will be closed overnight on:

- Sunday 18 June
- Sunday 2 July

Overnight working hours: Saturdays and Sundays 8pm - 6am. Our contractors may be on site for one hour's start-up and shutdown either side of these times.

#### What to expect

Overnight full road closures of the A43.

Speed restrictions on this section of the A43.

These dates may be subject to change due to circumstances outside of our control, such as weather.

These works are subject to consents.

#### What we will do

Respond promptly to any complaints and take appropriate action.



## Advance Work Notice

\*Update diversion route to avoid Towcester.

## Notification

### Notice of overnight road closures, A43, Brackley BP roundabout to the Syresham junction

[www.hs2.org.uk](http://www.hs2.org.uk)

#### Where will the works take place?

The map below, shows the section of the A43 that will have overnight road closures from the Brackley BP roundabout to the Syresham junction. The diversion route is via the A421, A422 and A5.

In addition to this notice, the road closure information will also be communicated through traditional road signage as well as electronic signage. These signs will be located in strategic locations and placed in a safe location. We would remind all road users to plan their journeys, allow more time and follow the signed diversion routes.

For the safety of road users and our workforce there will also be speed restrictions on this section of road. Periodic overnight lane closures will continue along this section of the A43, northbound and southbound, allowing us to progress our works for the temporary diversion of the A43.



Overnight working hours: Saturdays and Sundays 8pm - 6am. Our contractors may be on site for one hour's start-up and shutdown either side of these times.

#### What to expect

Overnight full road closures of the A43.

Speed restrictions on this section of the A43.

These dates may be subject to change due to circumstances outside of our control, such as weather.

These works are subject to consents.

#### What we will do

Respond promptly to any complaints and take appropriate action.



**Thank You**

